

RETROFIT ROOF INSTALLATION OVERVIEW SIMPLE SAVER SYSTEM®



601 North Main Street | PO Box 468 | Madison, NE 68748
800.255.0776 | thermaldesign.com

Please follow complete manufacturers instructions for safety, performance and effectiveness. The following information and detail overview is how our insulation and finishing systems are installed and shall only be used to understand the basic process.

Step 1: Install UVMAX® steel straps across the bay 24" to 30" on center by fastening at one end, pulling hand tight and fastening at ridge purlin, then pulling hand tight and fastening at opposite end.

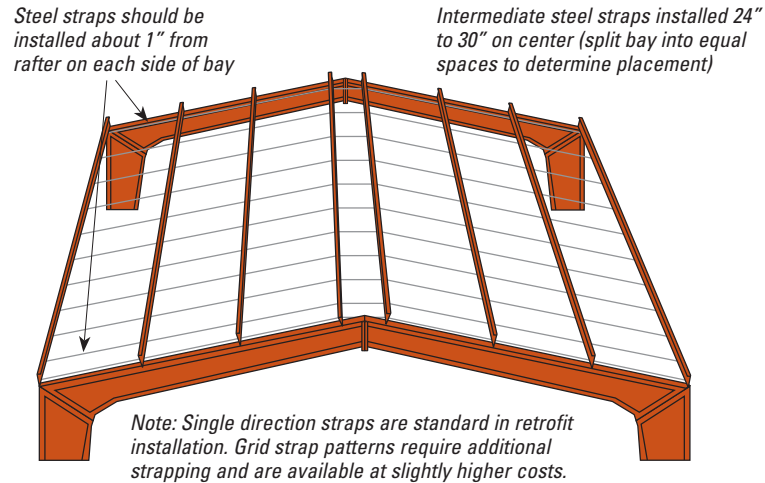

Step 2: Position the Syseal® liner fabric over intermediate straps between two purlins. Fasten one end of the fabric to the eave strut by backing out one fastener at a time, holding the straps, then pulling fabric to the wall line and replacing the fastener through the fabric into the same hole. Repeat this process for all intermediate straps.

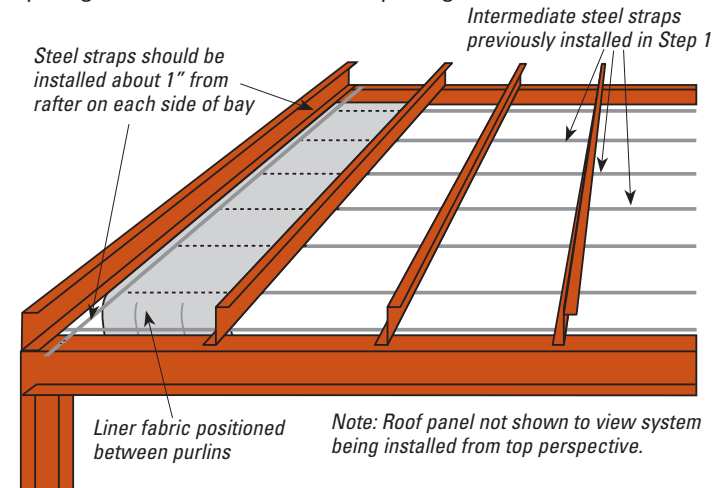

Step 3: Pull the Syseal® liner fabric stack toward ridge on the platform of steel straps. Pull one purlin space or several purlin spaces at once and install the fasteners. Then install the intermediate fasteners.

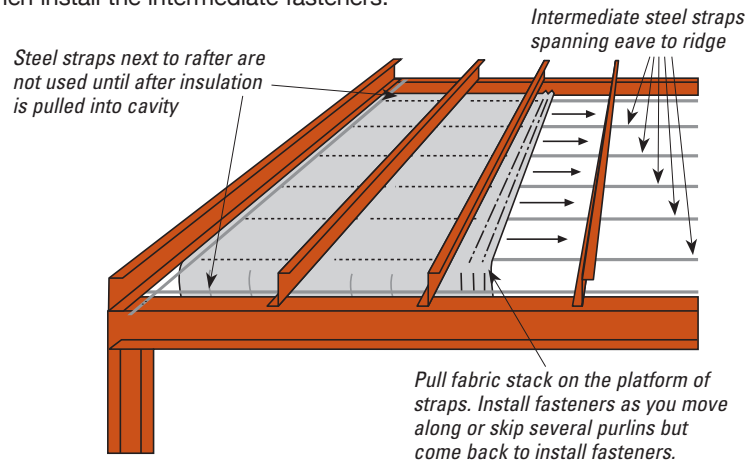

Step 4: Complete the installation of fabric across the bay.

Steel straps next to rafter are not used until insulation is pulled into position

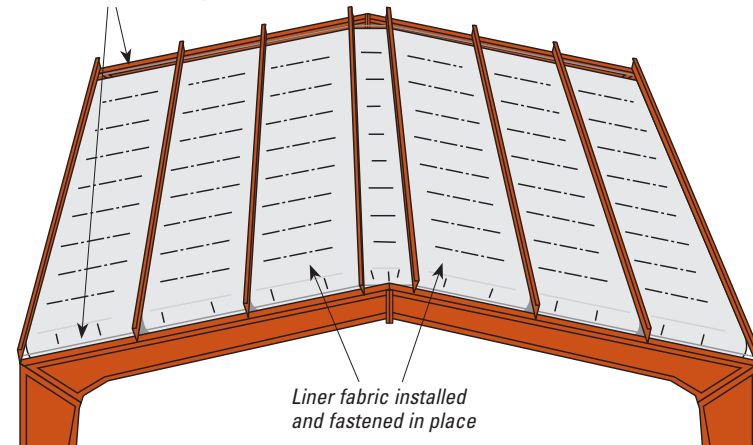

Insulation pulling boards available from Thermal Design.

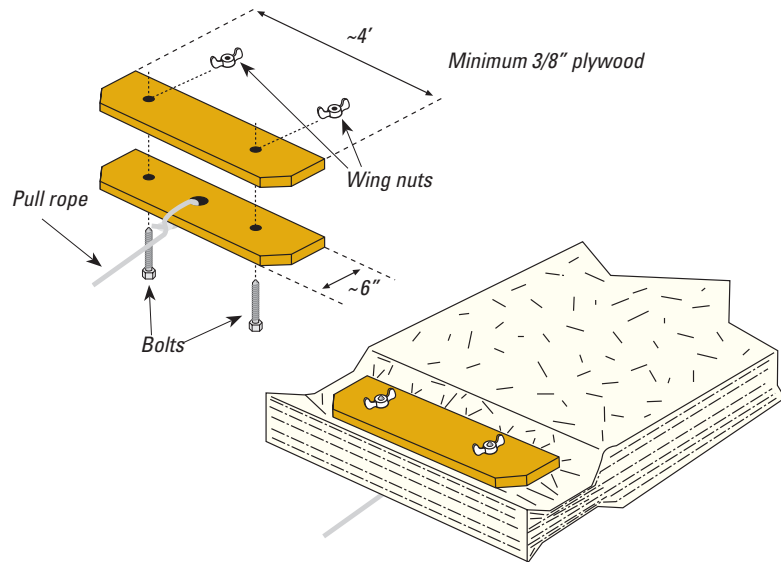

Step 5: Attach a batt of pre-cut insulation to the pulling board. Slide a tape measure above and across the liner system, attach a pull rope, and pull back across the suspended platform. Pull insulation into the purlin cavity as shown.

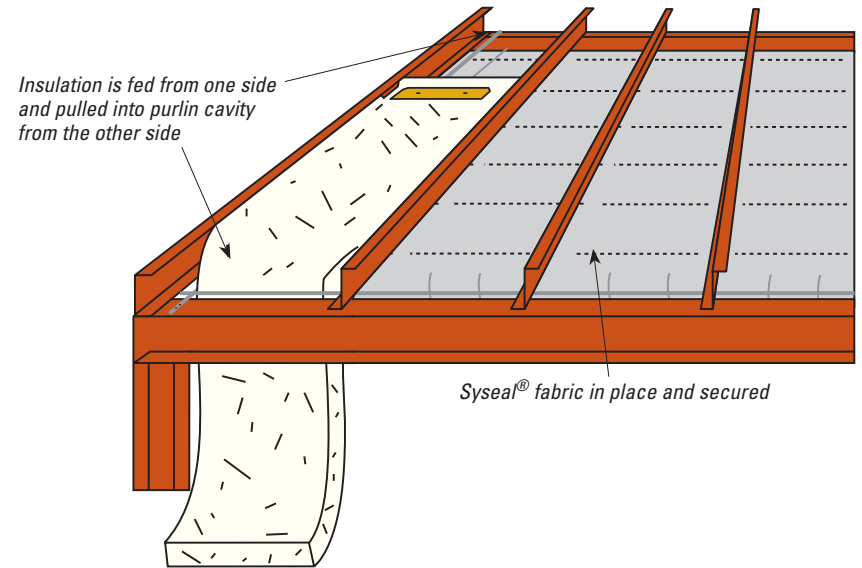

Cross sectional view of retrofit installation.

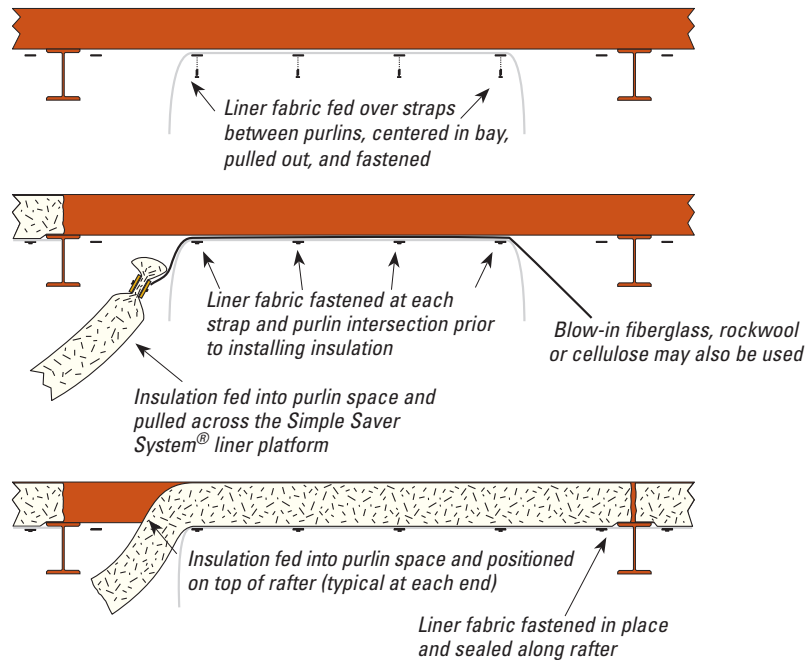

Cross sectional detail at the rafter.

