

# Overview Installation AutoCeil™

Ceiling and Wall Insulation System  
US Patents 8844230, 8991110, 9133623, others pending

## STEP 1 AutoCeil™ Sheet Set Up

Select and position AutoCeil™ Sheet along one sidewall base in the working bay. Align and temporarily fasten the end of the sheet and Compress-R to the base channel. Insert the Pull Tube into the AutoCeil Sheet Slits and attach Spreader Bars to the Pull Tube.

## STEP 2 Winch System Set Up

Secure the AutoCeil Winches at the opposite base and feed the Winch Cable up the sidewall, over the ceiling struts and down the opposite sidewall. Connect the cable ends to the Spreader Bar ring which is connected to the Pull Tube in the AutoCeil Slits.

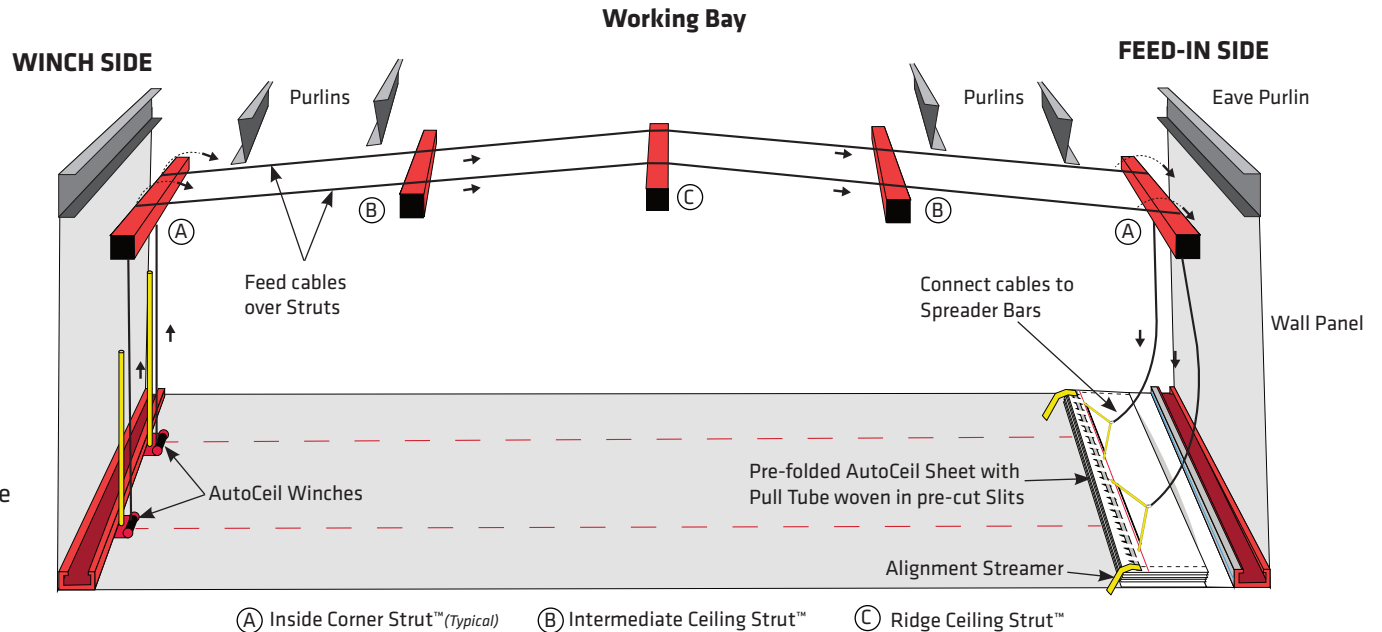

*Rafters, wall girts and all the purlins are not shown for simplicity of graphic.*

## STEP 3 Installing AutoCeil™ Sheet

Mechanically pull the AutoCeil Sheet up the sidewall, over all the ceiling struts and down the opposite sidewall using the Winch Controllers to steer the AutoCeil Sheet.

Once the Sheet is down the opposite sidewall, manually align the AutoCeil Sheet and mechanically fasten with Compress-R™ to the top of the Inside Corner Struts. Seal the 5" folded edge to top of the rafters using provided sealant.

AutoCeil Pull In Process

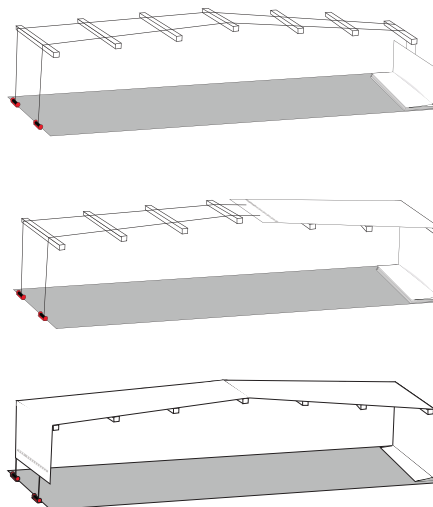

Inside Corner Strut Compress-R Installation

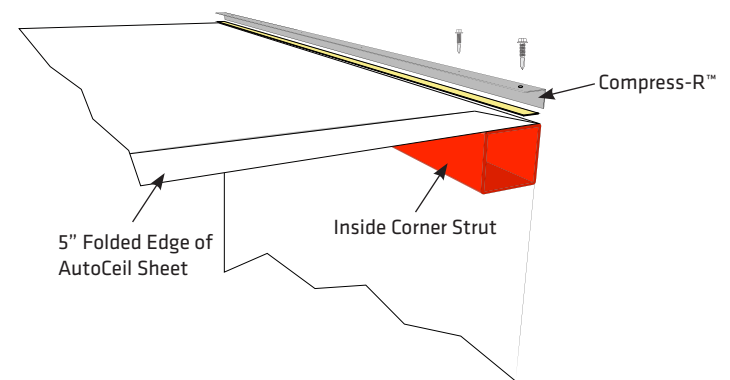

➤ Safer ➤ Faster ➤ Easier

**Thermal Design**  
INNOVATIVE ENERGY SAVING PRODUCTS  
800.255.0776 | thermaldesign.com



**STEP 4 Roof Insulation**

Unwrap unfaced insulation rolls or blankets, shake the insulation to achieve the required thickness and position the bottom layer neatly on top of the AutoCeil™ Sheet between the purlins. Add a top layer over the purlins as required. See project documents and drawings for details.

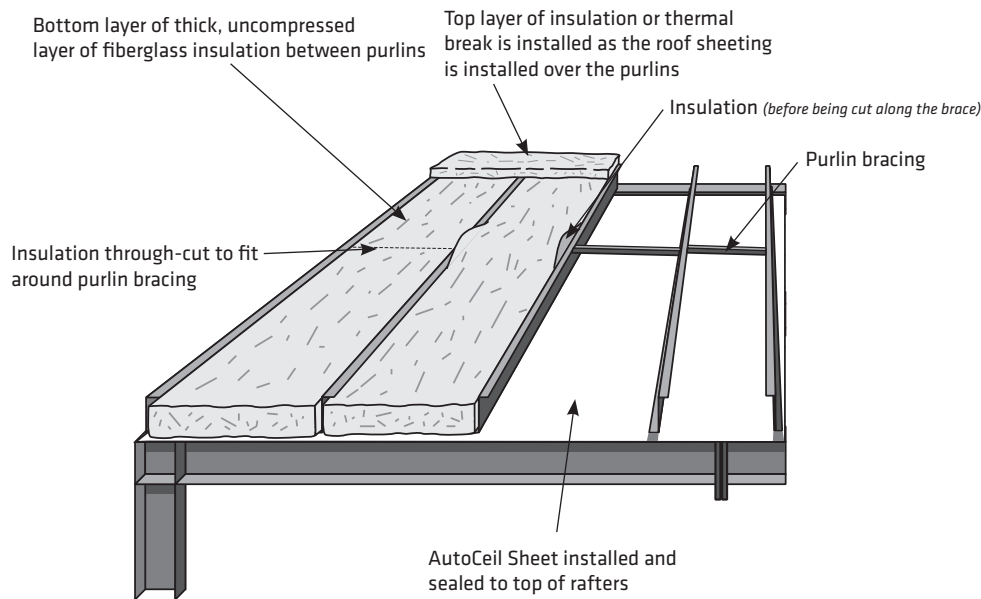

**STEP 5 Wall Insulation**

**Sidewall** - Clamp the hanging AutoCeil Sheet out of the way to access the wall cavity. Install Fast-R™ Insulation Hangers and impale uncompressed, unfaced fiberglass blankets neatly within the wall cavity. Align the AutoCeil Sheet with the center of the base channel using Sticky Tape and mechanically fasten Compress-R. Seal AutoCeil Sheet edges along each column using Sticky Tape XL (1.5 inches wide). Custom made Zee-Edge™ Trim is available for a mechanically fastened option vertically to the columns.

**Endwall** - Requires attachment along endwall rafters or bottom of the roof purlins with AutoCeil materials provided. Otherwise installation is similar to AutoCeil sidewall installation

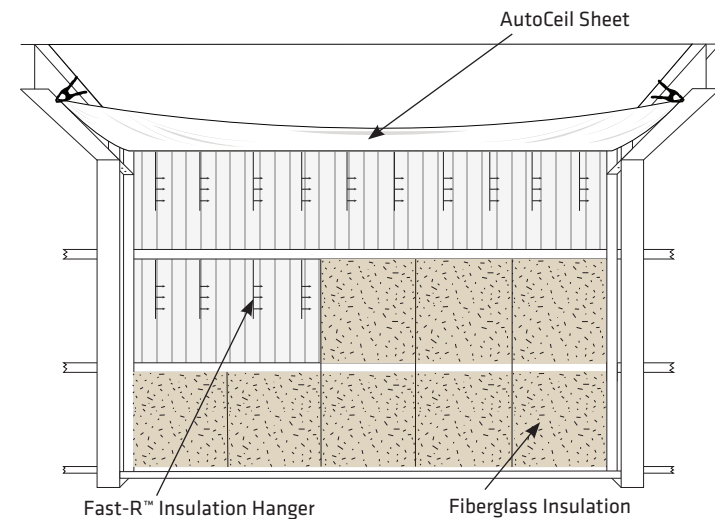

**No Rafter Brace Penetrations**  
**No Stand-off Roof Clips Required**  
**No Roof Spacer Blocks Required**



**No Bottom Side Banding**  
**No Bottom Side Ceiling Fasteners**  
**No Laminated Insulation**